

BASIC INFORMATION

Plastic ventilation system:

- It is designed for ventilation of residential premises (kitchens, bathrooms, toilets, etc.),
- it is a comprehensive, interconnected system of channels and fittings,
- The round system is available in diameters of 100, 125 and 150 mm,
- the flat system is available in the dimensions 110x55 mm (Ø100 equivalent) and 220x55 mm Ø125
- wall thickness 1.5 – 2 mm,
- individual components are made of high-quality PVC and ASA plastics,
- flat and round ducts have an antistatic treatment to prevent dust and bacteria from settling,
- temperature resistance of the material up to 80°C.

Installation:

- Individual components are connected by simply plugging them in.
- Joints can be sealed with silicone or aluminium adhesive tape.

The plastic ventilation system consists of the following elements:

Flat ducts (lengths 0.5 and 1 m), round ducts (0.5 and 1 m), tee, elbow, coupling, bracket, angle, transition piece, transition piece elbow, ventilation grille gravity damper, coupling with flap, transition piece with flap, poppet valve, reducer, condensate collector, plug, saddle branch.

Example of use:



Odp - zpracoval:	Ladislav Chloupek	Spr - schválil:	Jan Hájek	Datum:	
Podpis:		Podpis:		Strana / Počet stran:	1/16

Information on individual elements plastic ventilation system

1. Round Channel V

Material: PVC

USE: The round duct is the load-bearing element of the modular ventilation system. It is suitable for air distribution systems with connections to air-conditioning equipment such as hoods, heat recovery units, ventilators, etc., and to terminal elements such as ventilation grilles and disc valves. Aluminium flexi ducts AL FLEX can also be used to connect the duct with a ventilation grille. To switch from a flat channel to a round one, use transition pieces.

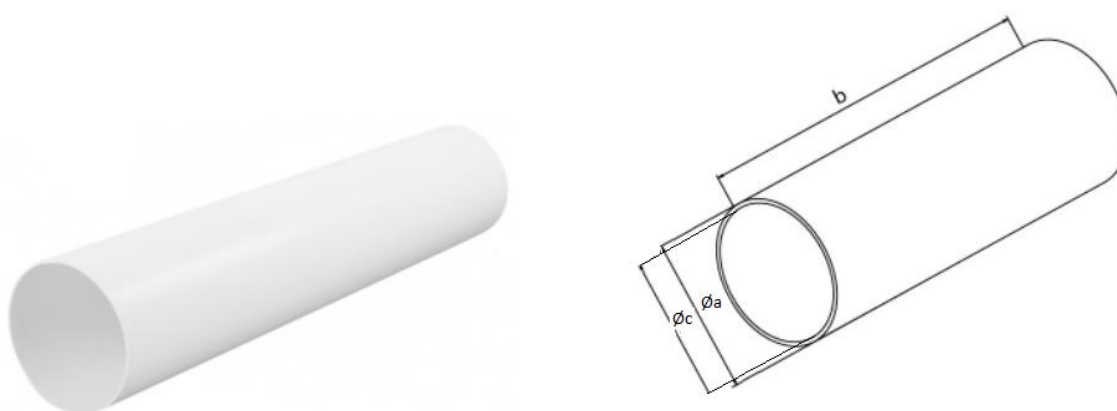

označení typu type	obj. číslo ord. code	barva color	rozměry [mm] / dimensions [mm]			ks/kart. pcs/box
			Ø a	b	Ø c	
V 154 × 1000	0646	bílá / white	154	1000	150	5
V 154 × 500	0647	bílá / white	154	500	150	10
V 129 × 1000*	0648	bílá / white	129	1000	125	8
V 129 × 500*	0649	bílá / white	129	500	125	16
V 104 × 1000	0621	bílá / white	104	1000	100	11
V 104 × 500	0622	bílá / white	104	500	100	22

*Adapter 125 je součástí kanálu V129 / Channel V129 includes adaptor 125

2. Flat Channel V

Material: PVC

Use: The flat duct is the load-bearing element of the modular ventilation system. It is suitable for air distribution systems with connections to air-conditioning equipment such as hoods, heat recovery units, ventilators, etc., and to terminal elements such as ventilation grilles and disc valves. Aluminium flexi ducts AL FLEX can also be used to connect the duct with a ventilation grille. To switch from a flat channel to a round one, use transition pieces. A flat duct can be used in places with a minimum ceiling height or generally where there is less space.

Odp - zpracoval:	Ladislav Chloupek	Spr - schválil:	Jan Hájek	Datum:	
Podpis:		Podpis:		Strana / Počet stran:	2/16

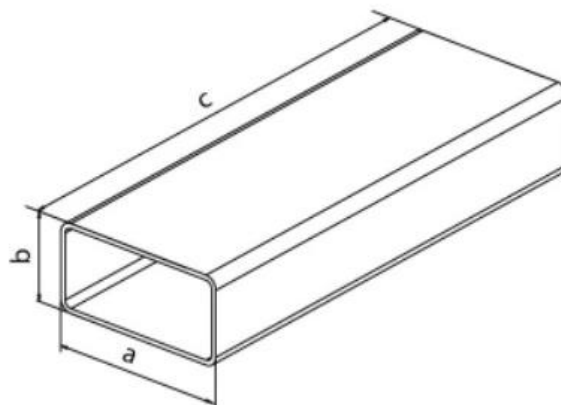

označení typu type	obj. číslo ord. code	barva color	rozměry [mm] / dimensions [mm]			ks/kart. pcs/box
			a	b	c	
V 220 × 55 × 1000	0644	bílá / white	220	55	1000	10
V 220 × 55 × 500	0645	bílá / white	220	55	500	20
V 110 × 55 × 1000	0632	bílá / white	110	55	1000	21
V 110 × 55 × 500	0613	bílá / white	110	55	500	42

3. Ventilation grille for flat duct VM

Material: ASA

Use: We install the grille by simply inserting it into the prepared flat channel or using silicone into the building hole.

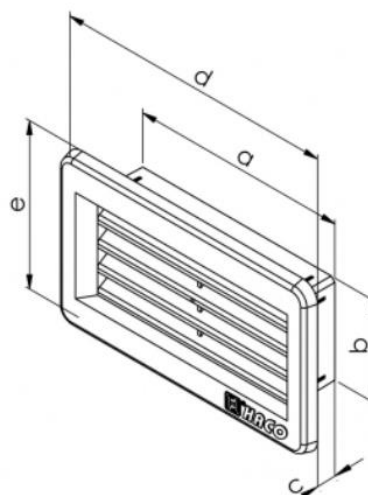

označení typu type	obj. číslo / ordering code	rozměry / dimensions [mm]					ks/kart. pcs/box
	bílá / white	a	b	c	d	e	
VM 220 × 55	0659	220	55	24	245	80	90
VM 110 × 55	0658	110	55	24	130	80	70

4.T Fitting Flat CTP

Material: ASA

Use: The T-fitting is used to connect flat ducts from three sides.

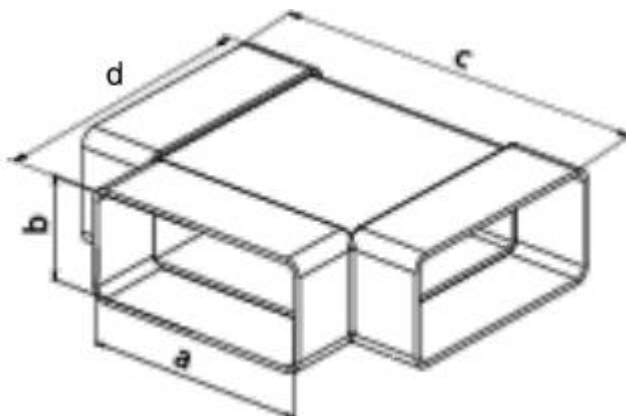

označení typu type	obj. číslo ord. code	barva color	rozměry [mm] / dimensions [mm]				ks/kart. pcs/box
			a	b	c	d	
CTP 3×220×55	0667	bílá / white	220	55	310	270	10
CTP 3×110×55	0614	bílá / white	110	55	188	150	28

5. Elbow horizontal flat CKH

Material: ASA

Use: We use a horizontal flat elbow to connect flat channels in corners.

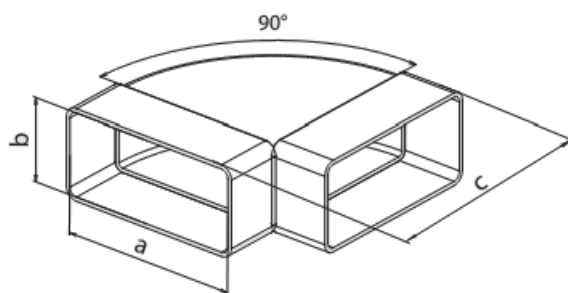

označení typu type	obj. číslo ord. code	barva color	rozměry [mm] / dimensions [mm]			ks/kart. pcs/box
			a	b	c	
CKH 2×220×55	0661	bílá / white	220	55	267	11
CKH 2×110×55	0615	bílá / white	110	55	152	35

6. CVP Flat Channel Coupler

Material: ASA

Use: The flat duct connector is used to connect two flat ducts when the system needs to be extended.

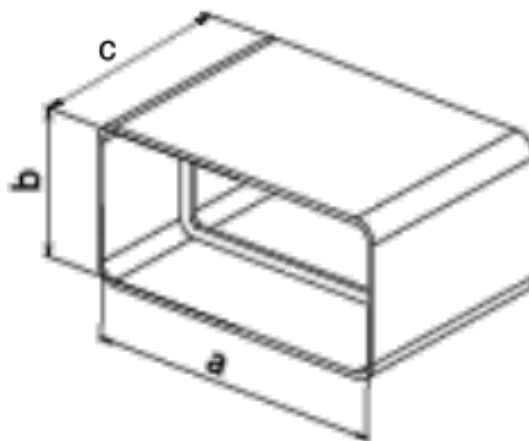

označení typu type	obj. číslo ord. code	barva color	rozměry [mm] / dimensions [mm]			ks/kart. pcs/box
			a	b	c	
CVP 220×55	0650	bílá / white	220	55	70	50
CVP 110×55	0616	bílá / white	110	55	70	50

7. Elbow vertical CKP

Material: ASA

Use: The vertical elbow is used to connect flat ducts in a vertical position in the corners

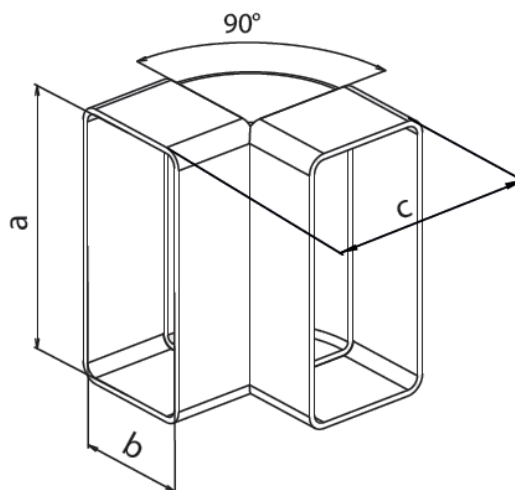

označení typu type	obj. číslo ord. code	barva color	rozměry [mm] / dimensions [mm]			ks/kart. pcs/box
			a	b	c	
CKP 2×220×55	0651	bílá / white	220	55	104	20
CKP 2×110×55	0617	bílá / white	110	55	99	40

8. UMP Flat Duct Bracket

Material: ASA

Use: The duct holder is suitable for attaching, attaching pipes to the ceiling in suspended ceilings or, for example, to a kitchen unit.

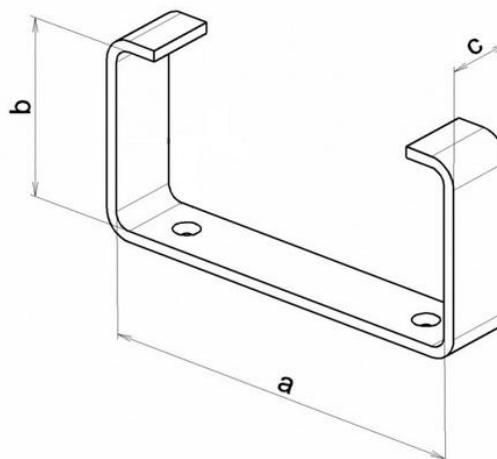

označení typu type	obj. číslo ord. code	barva color	rozměry [mm] / dimensions [mm]			ks/kart. pcs/box
			a	b	c	
UMP 220×55	0662	bílá / white	220	55	20	70
UMP 110×55	0619	bílá / white	110	55	20	100

9. CKW Angle

Material: ASA

Use: The angle is suitable for connecting flat pipes at a 45° bend.

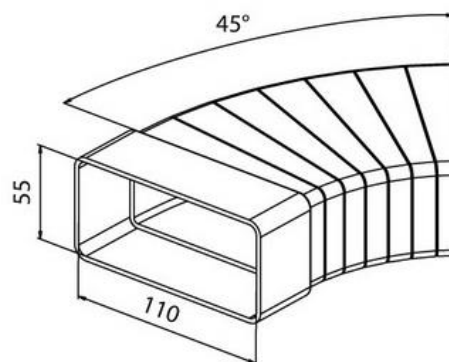

označení typu type	obj. číslo ord. code	barva color	rozměry [mm] / dimensions [mm]		ks/kart. pcs/box
			a	b	
CKW 2×110×55	0620	bílá / white	110	55	30

10. Round CTO T Fitting

Material: ASA

Use: The round T fitting is for connecting round pipes from three sides

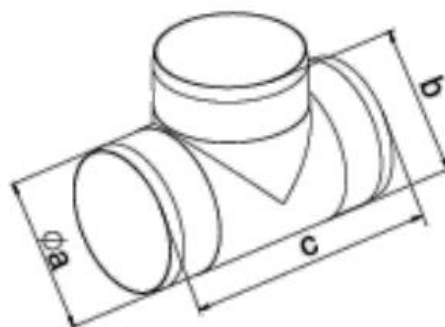

označení typu type	obj. číslo ord. code	barva color	rozměry [mm] / dimensions [mm]			ks/kart. pcs/box
			Øa	b	c	
CTO 3 × 125	0665	bílá / white	125	177	227	10
CTO 3 × 100	0623	bílá / white	100	143	185	20

11. Transition piece elbow CKZ

Material: ASA

Use: The elbow transition piece is adapted to connect a round and flat channel in the corners.

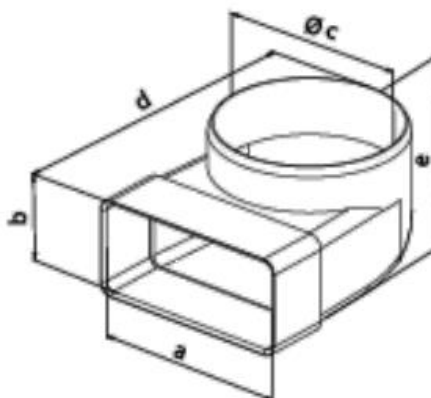

označení typu type	obj. číslo ord. code	barva color	rozměry [mm] / dimensions [mm]					ks/kart. pcs/box
			a	b	Ø c	d	e	
CKZ 125/220 × 55	0655	bílá / white	220	55	125	185	80	20
CKZ 100/110 × 55	0631	bílá / white	110	55	100	150	80	40

12. Round elbow CKO

Material: ASA

Use: The elbow is for connecting a circular pipe when a 90° bend is required.

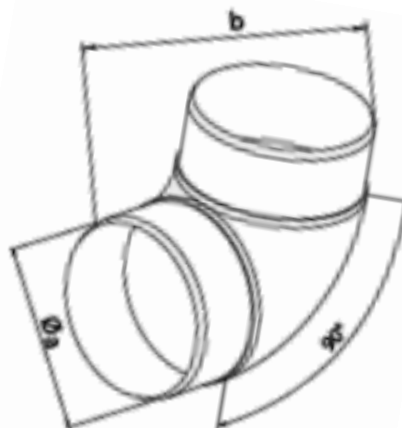

označení typu type	obj. číslo ord. code	barva color	rozměry [mm] / dimensions [mm]		ks/kart. pcs/box
			Ø a	Ø b	
CKO 90/150	0666	bílá / white	150	210	8
CKO 90/125	0663	bílá / white	120	174	15
CKO 90/100	0624	bílá / white	100	147	20

13. CVO Round Channel Coupling

Material: ASA

Application: The coupling is used to connect and extend round pipes.

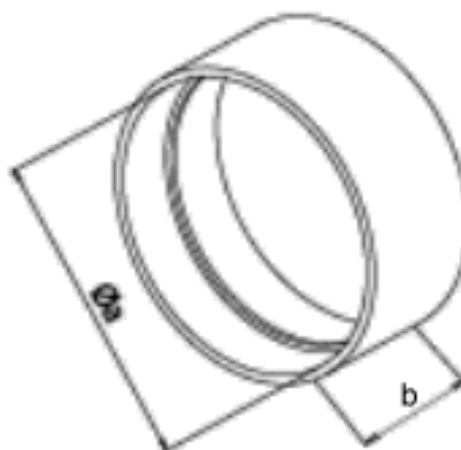

označení typu type	obj. číslo ord. code	barva color	rozměry [mm] / dimensions [mm]		ks/kart. pcs/box
			Ø a	b	
CVO 157	0652	bílá / white	154	60	30
CVO 132	0653	bílá / white	129	60	55
CVO 107	0625	bílá / white	104	45	100

14. UMO Round Channel Bracket

Material: ASA

Use: We will use the holder on a round pipe to attach it to the ceiling in the ceiling, or to the kitchen unit.

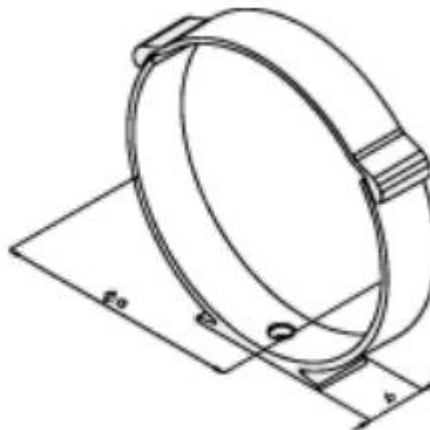

označení typu type	obj. číslo ord. code	barva color	rozměry [mm] / dimensions [mm]		ks/kart. pcs/box
			Ø a	b	
UMO 154	0673	bílá / white	154	25	35
UMO 129	0664	bílá / white	129	25	50
UMO 104	0626	bílá / white	104	20	45

15. CZD Transition Piece

Material: ASA

Use: The transition piece is suitable for connecting round and flat ducts with reduced space.

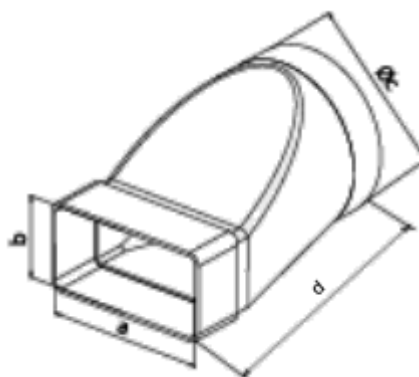

označení typu type	obj. číslo ord. code	barva color	rozměry [mm] / dimensions [mm]				ks/kart. pcs/box
			a	b	Ø c	d	
CZD 129/220×55	0654	bílá / white	220	55	129	210	10
CZD 104/110×55	0630	bílá / white	110	55	104	170	30

16. Gravity ventilation grille – VMGK damper

Material: ASA

Use: The ventilation grille is designed for the termination of a round duct. It is equipped with a removable canopy that provides protection against rain and weather conditions.

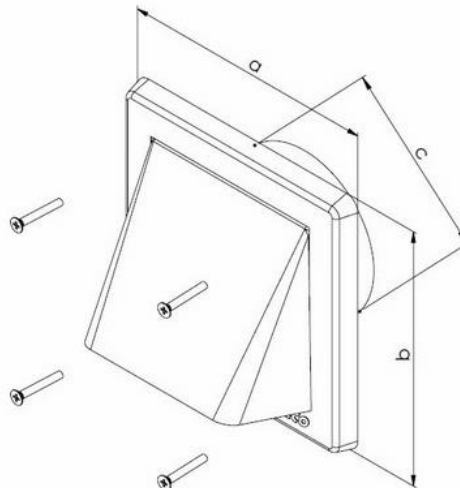

označení typu type	objednací číslo / ordering code	rozměry / dimensions [mm]			ks/kart. pcs/box
	bílá / white	a	b	Øc	
VM 175×175 GK/125 B	0240	175	175	118	28
VM 150×150 GK/100 B	0239	155	155	99	40

17. Plastic non-return valve ZKP

Material: ASA

Use: It is used to prevent backdraft in the pipeline.

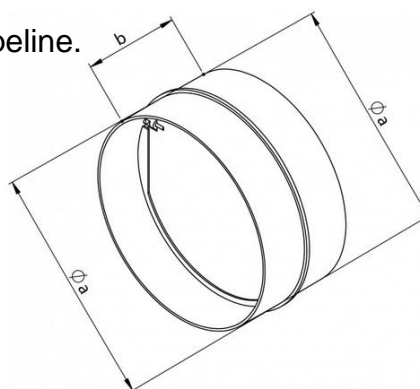

označení typu type	obj. číslo ord. code	barva color	rozměry [mm] / dimensions [mm]		ks/kart. pcs/box
			Øa	b	
ZKP 150	0672	bílá / white	150	60	10
ZKP 125	0669	bílá / white	125	60	60
ZKP 100	0695	bílá / white	100	60	90

18. Transition piece with CPC flap

Material: ASA

Use: The transition piece is used to connect round and flat pipes using a non-return valve to prevent the flow of cold air into the room.

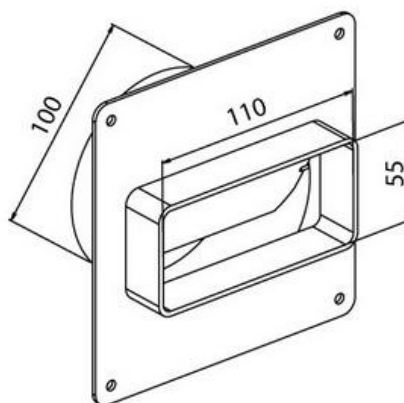
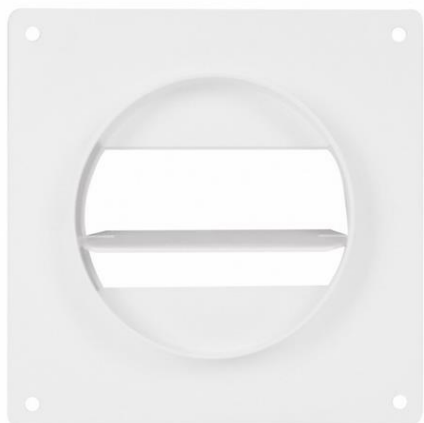

označení typu type	obj. číslo ord. code	barva color	rozměry [mm] / dimensions [mm]			ks/kart. pcs/box
			a	b	Ø c	
CZP 110 × 55/100	0629	bílá / white	110	55	100	40

19. Plastic non-return valve

Material: ASA

Use: It is used to prevent backdraft in the pipeline.

Installation: By simply inserting it into the flat channel.

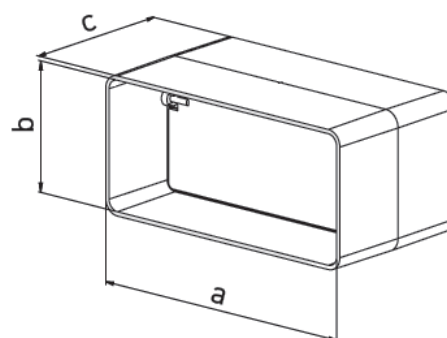

označení typu type	obj. číslo ord. code	barva color	rozměry [mm] / dimensions [mm]			ks/kart. pcs/box
			a	b	c	
ZKP 110 × 55	0692	bílá / white	110	55	60	50

20. TV Disc Valve

Material: ASA

Use: Can be used both outdoors and indoors. Can be closed completely.

Installation: With the help of three screws, the air supply is regulated by turning.

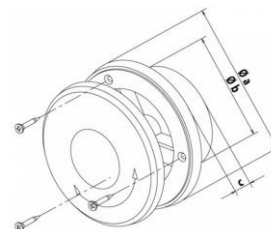

označení typu type	obj. číslo / ordering code	rozměry / dimensions [mm]			ks/kart. pcs/box
	bílá / white	Ø a	Ø b	c	
TV 150	0425	205	149	30	35
TV 125	0419	159	118	40	30
TV 100	0420	140	99	40	50

21. Double-leaf anti-odour flap PZKD

Material: The body of the damper is made of ABS plastic, the diaphragm is made of silicone, and there is a U-shaped rubber gasket around the perimeter of the damper, which increases the tightness and strength of the damper in the pipe. Long-term temperature resistance is 80°C and short-term temperature resistance is up to 85°C.

Use: Magnetic, double-leaf, self-acting damper that prevents odours from entering the room from the ventilation system.

Installation: By simply plugging it into the round channel V104. Ideal for use with extractor hoods, bathroom and toilet ventilation.

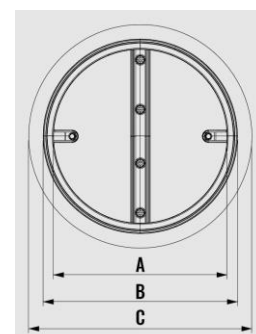

označení typu type	objednací číslo ordering code	rozměry [mm] / dimensions [mm]			ks/kart. pcs/box
		Ø a	Ø b	Ø c	
PZKD 200	0686	182	194	202	20
PZKD 160	0685	142	154	164	35
PZKD 150	0684	132	144	154	40
PZKD 125	0683	108	118	130	50
PZKD 100	0682	84	94	104	90
PZKD 80	0681	68	78	80	140

22. SBK condensate collector

Material: ASA

Use: A condensate collector is used to drain condensate from the system. These are mainly places where there is a big difference in temperature. An example is the exhaust of fumes from a kitchen hood using a plastic ventilation system that runs through the roofs. In this case, simply insulating the ducts is ineffective, as cold air continues to enter the ventilation system, especially when the hood is switched off. In this case, it is advisable to use a condensate collector as a part of the pipeline, which captures the resulting condensate and then gradually evaporates the condensate inside the collector. If the conditions of the ventilation system require it, we can also place more of these condensate collectors along the route. The SBK 100 and 125 collectors are newly supplemented with a funnel-shaped ring that better captures condensate flowing down the pipe wall (red in the pictures).

Installation: By simply inserting it into a standardized pipe and sealing the joint with tape or silicone. Recommended pipe inclination 1°- 45°.

Note: For SBK 100 and 125, 2 variants of condensate collection can be used:

A) Punching or drilling a partition in the drain neck and draining it into the sewer using a DN 32 pipe.

B) Leaving the partition in the drain socket and retaining the condensate in the evaporation compartment for gradual evaporation.

For SBK 100 and 125, DN 32 (1.1/4") pipes can be used to reduce condensate to drain

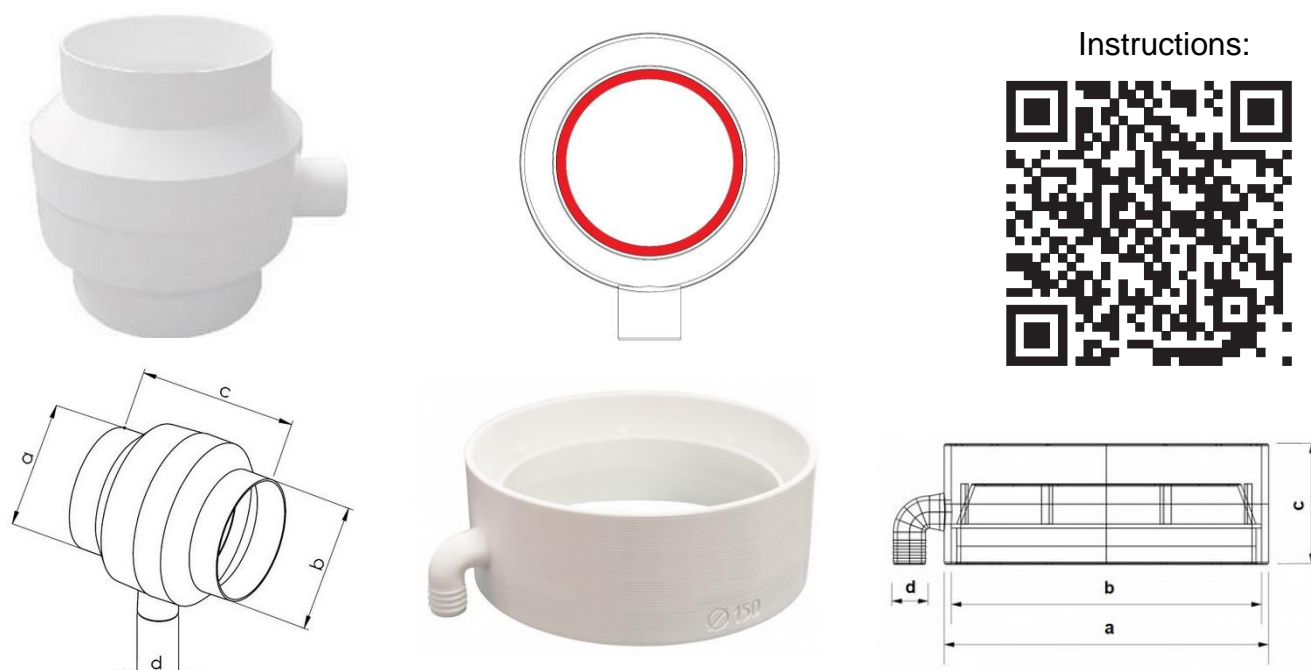

označení typu type	obj. číslo ord. code	barva color	rozměry [mm] / dimensions [mm]				ks/kart. pcs/box
			Ø a	b	c	d	
SBK - V 150	0674	bilá / white	155	162	60	16	30
SBK 125	0671	bilá / white	125	125	136	32	15
SBK 100	0660	bilá / white	100	132	135	32	24

Odp - zpracoval:	Ladislav Chloupek	Spr - schválil:	Jan Hájek	Datum:	
Podpis:		Podpis:		Strana / Počet stran:	13/16

23.SBK flat collector with condensate drain

Material: ABS

Use: A condensate collector is used to drain condensate from the system. These are mainly places where there is a big difference in temperature. Such as, for example, the exhaust fumes from the kitchen hood using a plastic ventilation system that runs through the roofs. In this case, simply insulating the ducts is ineffective, as cold air continues to enter the ventilation system, especially when the hood is switched off. Here it is convenient to use as a part of a flat pipe. This condensate collector captures the resulting condensate and discharges it to the drain through a \varnothing 12mm mouthpiece. If the conditions of the ventilation system require it, we can also place more of these condensate collectors along the route.

Installation: By simply inserting it into a standardized pipe and sealing the joint with tape or silicone.

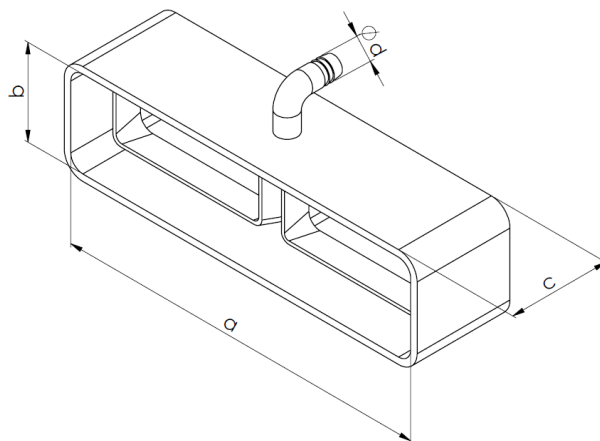
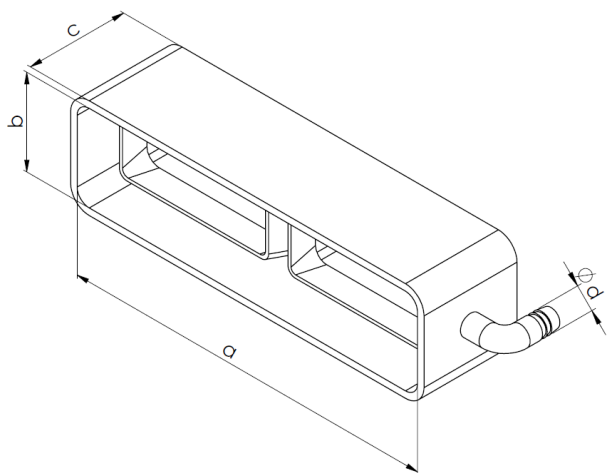

označení typu type	obj. číslo ord. code	barva color	rozměry [mm] / dimensions [mm]				ks/kart. pcs/box
			Ø a	b	c	d	
SBK 220×55 B	0691	bílá / white	220	55	60	12	50
SBK 220×55 P	0690	bílá / white	220	55	60	12	40
SBK 110×55 B	0689	bílá / white	110	55	60	12	40
SBK 110×55 P	0688	bílá / white	110	55	60	12	35

Odp - zpracoval:	Ladislav Chloupek	Spr - schválil:	Jan Hájek	Datum:	
Podpis:		Podpis:		Strana / Počet stran:	14/16

24. Plastic RP reducer

Material: ASA

Use: Plastic reducers are used for the transition of ventilation systems of different diameters

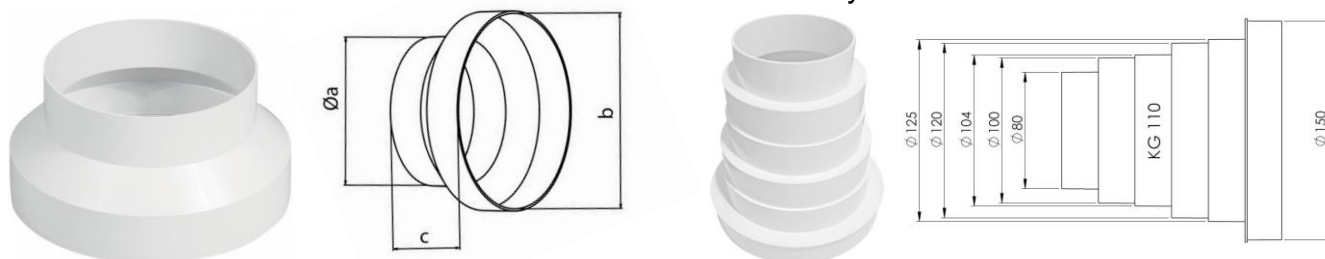

označení typu type	obj. číslo ord. code	barva color	rozměry [mm] / dimensions [mm]							ks/kart. pcs/box
			Ø a	b	c	d	e	f	g	
RP 80 - 150	0687	bílá / white	80	100	150	104	120	125	150	25
RP 125/150	0657	bílá / white	125	158	66	-	-	-		35
RP 100/125	0656	bílá / white	100	129	66	-	-	-		50

25. Saddle branch

Material: ABS

Use: The saddle branch is used to extend the ventilation system. The saddle branch can be easily snapped onto existing pipes and then make a hole with a suitable tool (jigsaw, hacksaw, etc.). Suitable for renovations. The saddle branch has a stop inside to prevent the connected duct from being pushed in too much, which would create an obstruction to the air flow. The exact dimensions can be found on our e-shop www.shop.haco.cz.

Installation: Suitable for connecting Haco channels. The saddle branch is snapped onto the pipe, a hole is made and a new pipe is connected. It is advisable to seal the joints with universal silicone.

Montážní návod



E-shop



označení typu type	obj. číslo ord. code	barva color	ks/kart. pcs/box
SO 100/100	0696/1	bílá / white	15
SO 125/125	0696/2	bílá / white	20
SO 150/150	0696/3	bílá / white	10
SO 110×55 P	0696/4	bílá / white	30
SO 110×55 B	0696/5	bílá / white	20
SO 220×55 P	0696/6	bílá / white	15
SO 220×55 B	0696/7	bílá / white	55
SO 110×55/100 PP	0696/8	bílá / white	20
SO 220×55/125 PP	0696/9	bílá / white	20

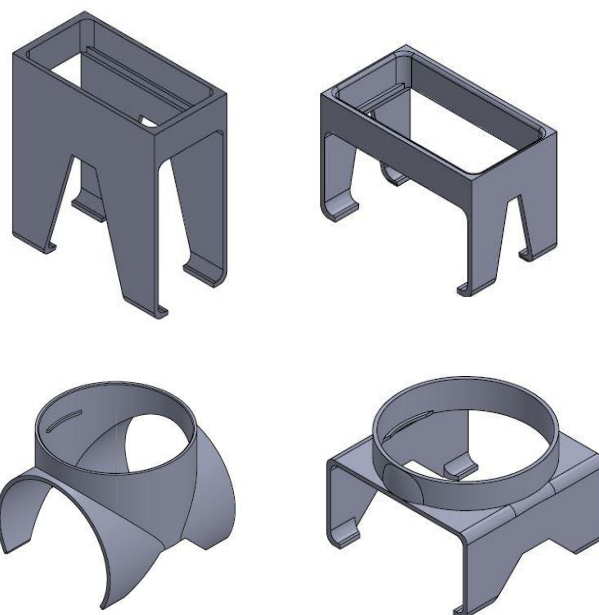

26. Round stopper / Flat stopper

Material: ASA

Use: Plastic reducers are used for the transition of ventilation systems of different diameters

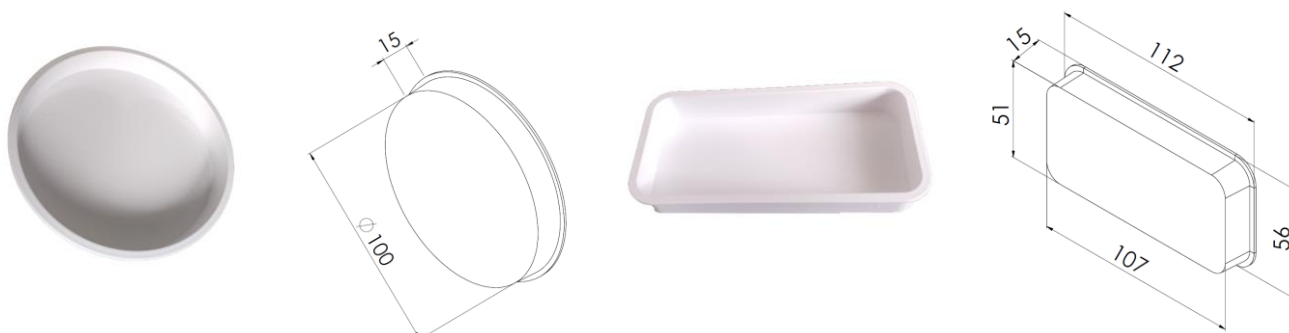

označení typu type	obj. číslo ord. code	barva color	rozměry [mm] / dimensions [mm]					ks/kart. pcs/box
			Ø a	b	c	d	e	
ZK 100	0694	bílá / white	100	115	15	-	-	120
ZP 100 × 55	0693	bílá / white	107	51	112	56	15	250

For more information, please contact www.haco.cz or our sales representatives:

1 Zuzana Matuchová
tel.: +420 606 837 411
e-mail: zuzana.matuchova@haco.cz

2 Ladislav Chloupek
tel.: +420 739 464 938
e-mail: ladislav.chloupek@haco.cz

